

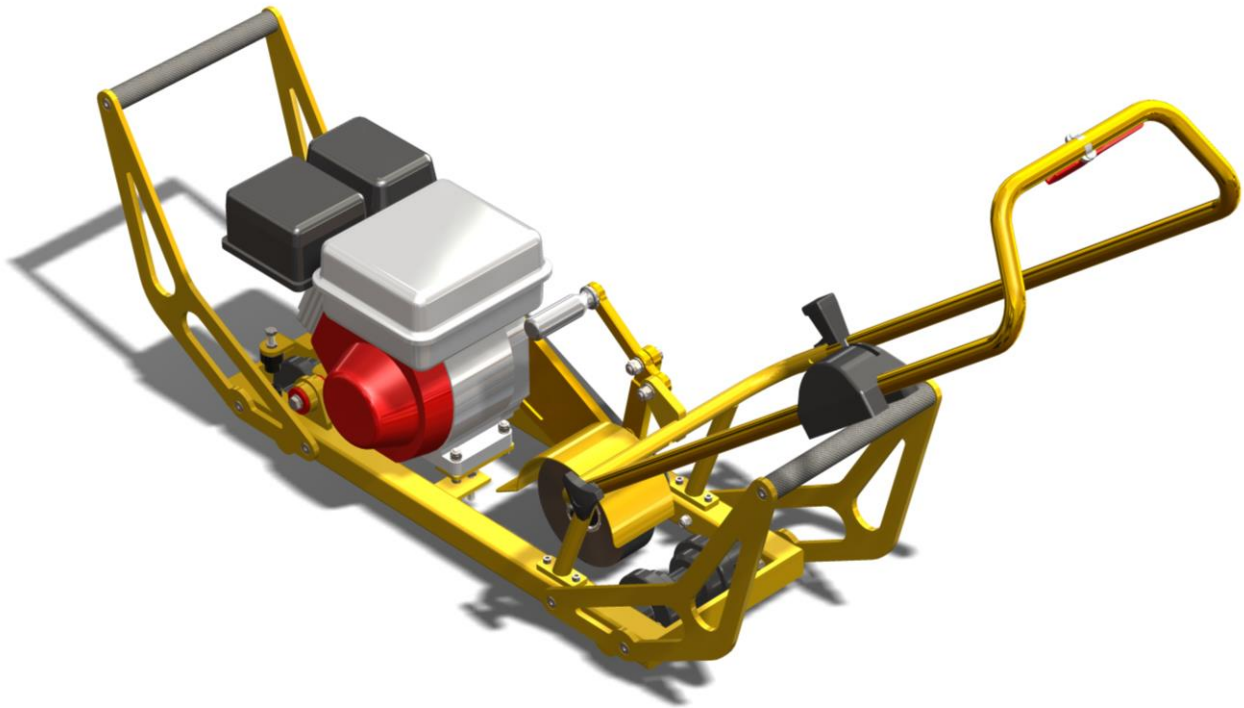

Rail Scrubber

Technical Specification



Description:

The Rail Scrubber has been designed to allow rapid and easy cleaning of railhead in situations where train borne equipment is either too expensive or impractical. It is for use by a single operator on short stretches of track where a clean rail head is required quickly.

The Rail Scrubber is powder coated yellow for high visibility when on track and fitted with two 24watt/12volt LED lamps that make working in the dark much easier.

Please note:

All information, illustrations and specifications in this Technical Sheet are based on the latest information available at the time of publication. The right is reserved to make changes at any time without notice.

Equipment operators and installers shall be responsible for ensuring that a safe working environment and safe systems of work are in place and in certain circumstances advice and permission from the controlling authority must be sought before any operation, installation or surveying work is carried out.

Permaquip™ is a trademark of Permaquip Ltd.

©2006 Permaquip Ltd.

Permaquip Ltd, Brierley Industrial Park, Stanton Hill, Sutton-In-Ashfield Nottinghamshire, NG17 3JZ

Tel: +44 (0)1623 513349 / Fax: +44 (0)1623 517742

E-mail: sales@permaquip.co.uk / www.permaquip.co.uk

Rail Scrubber Layout:

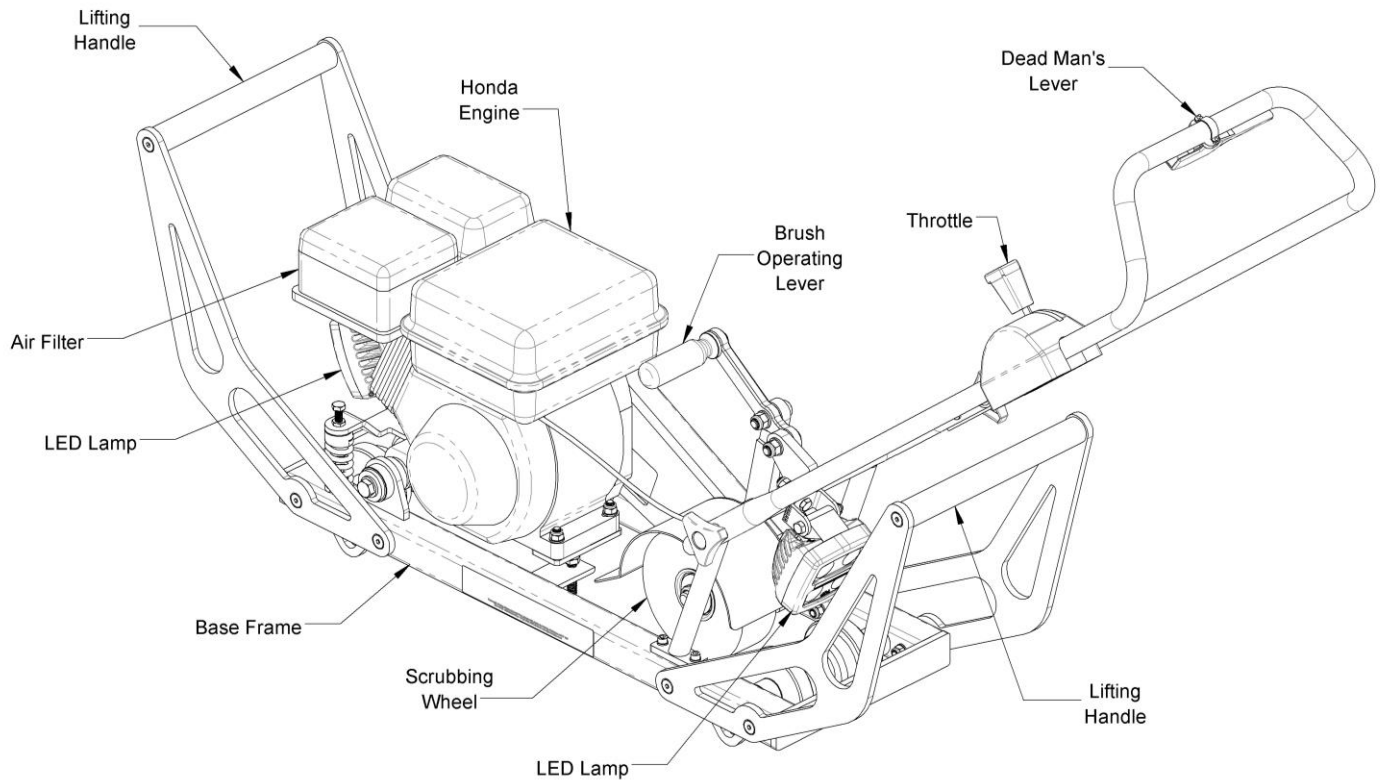

Technical Data:

Rail Scrubber Part Number:	RS200H
Overall dimensions:	
• Length	1175mm / 1565mm
• Width	445mm
• Height (Handle Upright)	974mm
Mass:	47kg
Noise Emissions:	
• No load (adjacent to operator)	75.5dBA
• Full load (adjacent to operator)	89dBA
Vibration Readings:	Aeq $\Sigma 8.42ms^2$
• Time to reach EAV (Exposure Action Value)	42mins/man per day
• Time to reach ELV (Exposure Limit Value)	2hrs 50mins/man per day

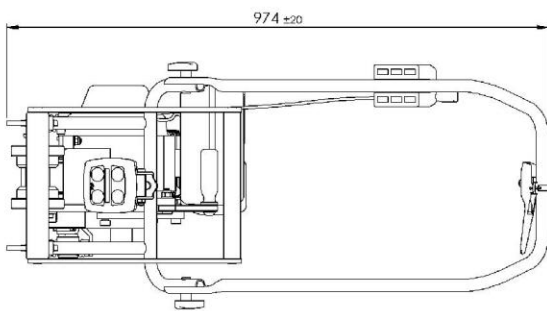
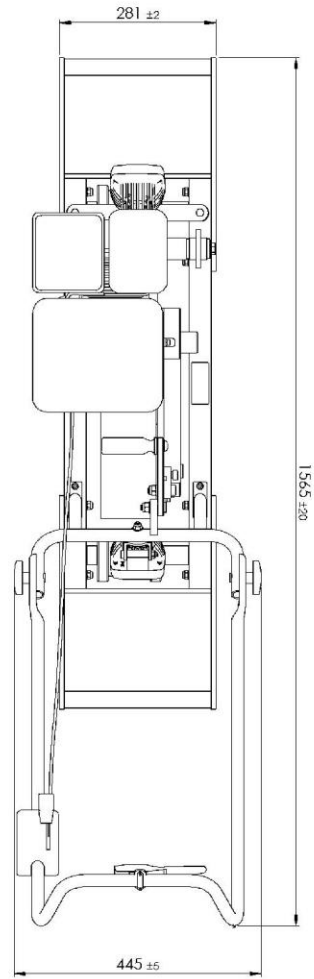
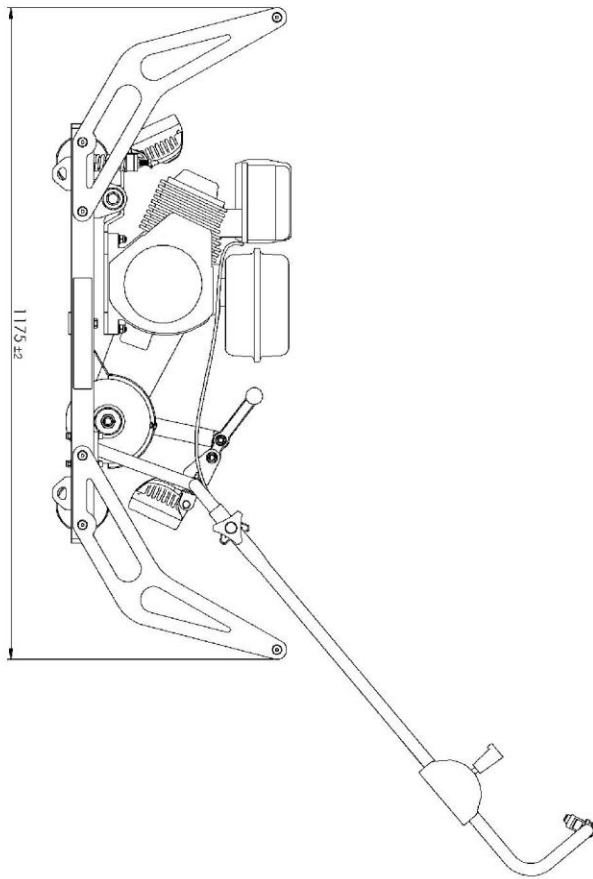

Rail Scrubber