

Handling Equipment

Lifting Beams – Fixed and Adjustable

A range of beams are available in a variety of lengths with capacities up to 300 tons.



Fixed Lifting Beams



Adjustable Lifting Beams

Switch and Crossings Lifting Beam

0.5m long Lifting Beam with chains 5T capacity **Part No. 1121064**

Sleeper Laying Beam

The standard range of Sleeper Lifting Beams with an odd number of Droppers (3, 5, 7) are configured for Sleeper Laying utilising alternate dropper chain assemblies.

When beams are ordered for laying purposes please advise your spacing requirements. Should you have multiple spacing requirements Melvelle Equipment can supply you with adjustable beams. Please call to discuss your specification.

Specification

Beam, chains and hooks

Part No.	No. of Sleepers (Laying)	Sleeper Centres (mm)
1120588	3	500
1120592	4	500
1120605	4	600
1120808	4	Adjustable
1120913	7	Adjustable



Other laying beam and sleeper centre configurations available upon request.

Sleeper Lifting Beams



Sleeper lifting beams are available in various styles with either fixed or adjustable centres, allowing for the differing sleeper spacing's.

In addition depending upon the type of beam, a wide variety of dropper chain configuration and sleeper hooks are available.

The standard range of Sleeper Lifting beams are configured for loading, with dropper chains fitted at half sleeper spacing.

E Clip Hook



E Clip dropper chain assembly

Part No. – **1120810**

E-Clip Lifting Hook only

Part No. – **1120891**

Fast Clip Hook



Fastclip dropper chain assembly

Part No. – **1120809**

Fastclip Lifting Hook only

Part No. – **1120892**

Sleeper Lifter



Sleeper Lifter only

Part No. – **1120893**

Rail Handing Beams

Beams are available for handling 9m (30ft), 13.5m (45ft) and 18m (60ft) long rail sections.

These beams can be fitted with various types of rail clamps detailed in the section or can be used with webbing slings.

All beams are manufactured with a centre lifting eye as standard.

In addition to this they are also fitted with lifting lugs at each end for use with double leg sling.



Specifications

Part No.	Capacity (kg)	Beam Length	Rail Length
1120793	1,000	4.0m	9m (30ft)
1120793-3	3,000	4.0m	9m (30ft)
1120793-B	1,500	7.5m	18m (60ft)
1120793-M	10,000	8.5m	5x 25m

Camlok Rail Lifting Clamps – Type CR

These clamps are designed to lift most sizes of rail in use in Australia. The clamp is either fitted with a hook ring for direct connection to the crane, or with a plate link for fitment with a short chain assembly.

Beam Length	Rail Length	Capacity (kg)	Part No.
4.0m	9m (30ft)	1,000	1120589
7.5m	18m (60ft)	2,000	1120590

Description	Part No.
Chain & shackle (attaches to clamp)	1120966



Drag Clamp



The 12 ton Drag Clamp is for fitting over the head of the rail, and is a means of dragging or pulling lengths of rail up to 183m (600ft) long safely. The clamp is used with various formats of tow chain and wire ropes, the most popular being a 2m or 4m long, 16mm grade 8, twin chain sling with large master link at each end (minimum breaking load 42.4 tonnes).



Description	Part No.
Rail Drag Clamp 12T WLL (60kg,68kg)	1120796
Shear link assembly with shackles	1120797
Chain for drag clamp 16mm x 4m	1120798
Chain for drag clamp 16mm x 2m	1120799



Description	Part No.
Rail Dragging cam 20T WWL (41-68kg)	1121119
Rail Pulling cam 20T WWL R:57kg Tram Rail	1121119-57
Rail Dragging cam chain assembly: Consisting of 1 leg x 5m long x 16mm chain	1121119-CH

Ironman

For transporting, lifting and transposing rail, the Ironman is generally used in pairs. The standard model is fitted with a **1120791** – 1,500kg Yale Pull-Lift and a **1120589** – 1,000kg Camlok rail clamp.

Each unit requires two persons for assembly and is easily dismantled for storage and transportation.

Unit is fully braked and approved by Network Rail UK.

TOC Waver also available.



Part No. 1120790 - 1435
(includes 1120791 & 1120589)

Adaptor link



2-Rail Carrier

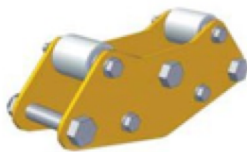

Red LED Light



Camlok Rail Clamp



LUL Rail Clamp



Rail Storage Bracket



Product	Part No.	Mass (kg)	Cert. No.	SWL
Ironman c/w lifting equipment	28957	153	PA05/03385	1500kg
LUL Ironman c/w lifting equipment	28717	141	PE007/1057	1500kg
Ironman w/o lifting equipment	28397	112		1500kg
LUL Ironman w/o lifting equipment	33273	104		1500kg
2-Rail Carrier	35212	4.0		1000kg
Rail Storage Bracket	28511	7.0		500kg
Adaptor Link (for use with Camlok)	27924	1.0		1500kg
Camlok Rail Clamp	04059005	12.5		1000kg
LUL Rail Clamp	06275	8.5		1500kg
Yale Pul-Lift	04059002	15.0		1500kg
S&C lifting chain	28640	6.0		3150kg
Red LED light	04082021	0.1		N/A
Top Beam		31		
Braked End Frame Assembly		36		
UnBraked End Frame Assembly		34		
Bottom Cross beam		11		

Multi-Rail Handler

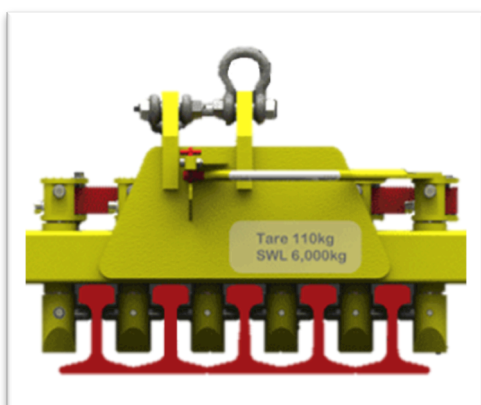

3 Rail Lift

Part No. **1121020-3**

5 Rail Lift

Part No. **1121020-5**

6 Rail Lift

Part No. **1121020-6**

9 Rail Lift

Part No. **1121020-9**

The Multi-Rail Lifter is designed for the handling of bulk rail deliveries. Both manual and hydraulic versions are available.

Multi-Rail Lifters can be made to suit any rail section including conductor and grooved rails.

Rapid Loading and Unloading of Rails

Specification

Weight	115kg
Height (mm)	495
Width (mm)	290
Length (mm)	890
Max Hyd Pressure	190 Bar
Min. Hyd Pressure	90 Bar



Rail Handling “A” Frames



- “A” Frames are rated to 500kg each
- Total mass 78kg each
- Cross beam weight 34kg
- “A” Frame ends 22kg each
- Lifting block and tackle to 500kg capacity available on request

Part No. **1121219**